

Description

The MyHOME Server is a device designed to interact with the MyHOME_Up system⁽¹⁾ by means of the MyHOME_Up app for smartphone and tablet (available in the stores for Android and iOS systems).

In particular thanks to this device one can:

Start the MyHOME system

- Concerning the Lights⁽²⁾ and Automation⁽²⁾ systems the system is started via the MyHOME Server directly using the MyHOME_Up application.
- The temperature control, energy management and touch screen systems can be configured via the MyHOME Server using the MyHOME_Suite PC software.

Interact with the MyHOME system

- the MyHOME_Up⁽³⁾ system can be controlled via the MyHOME Server and third party devices⁽⁴⁾ via the MyHOME_Up application. By means of the MyHOME Server/MyHOME_Up combination both the installer and the final user can add or customise scenarios and schedulings.

⁽¹⁾ **Note: MyHOME Server is only compatible with the MyHOME_Up application and with the MyHome_Suite software.**

⁽²⁾ For correct operation it is fundamental that the connection is made on the private riser BUS (level 3) of the automation system (see MyHOME Automation Guide).

⁽³⁾ The MyHOME Server manages the Light, Automation, Temperature control and Energy Management systems.

⁽⁴⁾ For example one can interact with Philips Hue and Lixif lamps, Nuvo audio systems, ...

Technical data

Power supply from SCS BUS:	18 - 27 Vdc
Supplementary power supply (optional):	18 - 27 Vdc
Absorption from SCS BUS without additional power supply:	130 mA max
Absorption from SCS BUS with additional power supply:	3 mA max
Absorption from additional power supply:	160 mA max
Operating temperature:	5 - 35 °C
Default fixed IP address:	192.168.0.55

Dimensional data

Size: 6 DIN modules

Front view

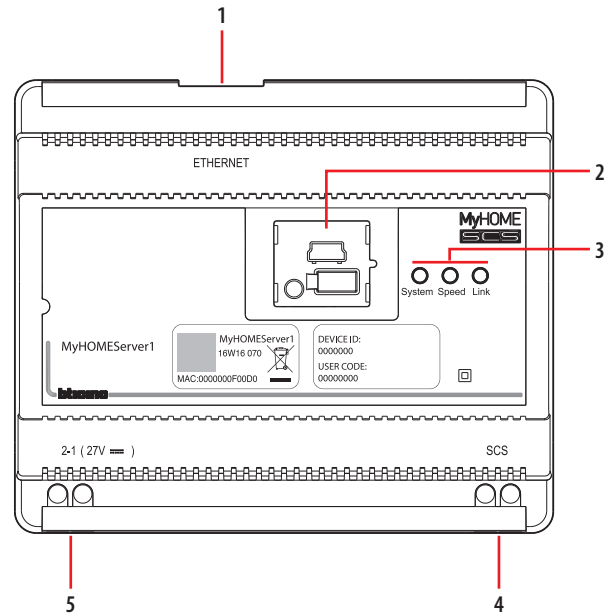

Legend

1. RJ45 for Ethernet LAN 10/100 Mbit
2. Under the door are:
 - USB port
 - RESET pushbutton (to change to DHCP Dynamic IP keep pressed for 10 s)
 - RS232 serial connection
3. User interface:
 - Speed: Connection speed: ON = 100 Mbit/s
OFF = 10 Mbit/s
 - Link: When on, it indicates that the Ethernet network has been found
 - System: On connecting the power supply it switches on and off and the next time it switches on it indicates that MyHOME Server is operative
4. 2 wire BUS for connection to the MyHOME system
5. Supplementary power supply (optional) (27 Vdc)

Devices which can be directly associated via MyHOME Server

Description	Legrand code	From production batch:	BTicino code	From production batch:
Scenario control	LG-573902	08W51	BT-L4680	09W08
	LG-573903	08W51	BT-N4680	09W08
	LG-574503	all	BT-NT4680	09W08
	LG-574504	all	BT-HC4680	09W08
	LG-067217	all	BT-HD4680	09W08
	LG-067218	all	BT-HS4680	09W08
	LG-078478	all		
SCS/SCS interface	LG-003562	12W20	BT-F422	12W20
Touch multifunction control	LG-067243	13W05		
	LG-067244	13W05		
	LG-067245	13W05		
BUS 8-key control	LG-067592	all	BT-LN4652	all
			BT-H4652	all
2 m basic control	LG-067552	all	AR-64360	09W40
			BT-H4652/2	09W40
			BT-L4652/2	09W40
			BT-AM5832/22	09W40
3 m basic control	LG-067554	all	BT-L4652/3	09W40
			BT-H4652/3	09W40
			BT-AM5832/3	09W40
BUS shutter actuator	LG-067557	all	BT-LN4661M2	all
			BT-H4661M2	all
			BT-AM5861M2	all
BUS shutter control	LG-067558	all	BT-LN4660M2	all
			BT-H4660M2	all
			BT-AM5860M2	all
Special control	LG-067553	all	AR-64362	all
			BT-L4651M2	08W41
			BT-H4651M2	08W41
			BT-AM5831M2	08W41
16A 100/240V 1 relay DIN actuator	LG-003847	all	BT-F411U1	all
16A 100/240V 2 relay DIN actuator	LG-003848	all	BT-F411U2	all
16A 100/240V 1 relay DIN actuator	LG-003841	10W17	BT-F411/1N	09W13
16A 2 relay DIN actuator	LG-003842	10W18**	BT-F411/2	09W04**
16A 100/240V 2 relay DIN actuator	LG-002601	all	BT-BMSW1002	all
16A 100/240V 4 relay DIN actuator	LG-002602	all	BT-BMSW1003	all
6A 4 relay DIN actuator	LG-003844	10W22*	BT-F411/4	09W04*
16A 100/240V 4 relay DIN actuator	LG-002604	all	BT-BMSW1005	all
4 output DIN actuator for 0-10V ballast	LG-002612	all	BT-BMDI1002	all
DIN actuator for 0-10V ballast	LG-003656	10W05	BT-F413N	09W14
Basic contact interface	LG-573996	10W04	BT-3477	10W04
DIN contact interface	LG-003553	10W13	BT-F428	09W50

* If the device is installed on the output of the F422 interface, the minimum batch is 15W25

** If the device is installed on the output of the F422 interface, it is not possible to associate it using the APP. It is recommended to replace it with the code F411U2

Description	Legrand code	From production batch:	BTicino code	From production batch:
1000 VA DIN dimmer	LG-002621	all	BT-F416U1	all
1000 W DIN dimmer	LG-003652	09W50	BT-F414	09W29
400 VA DIN dimmer	LG-003653	10W07	BT-F415	09W22
2 x 400 VA DIN dimmer	LG-002622	all	BT-F417U2	all
300 VA DIN dimmer	LG-003665	all	BT-F418	all
2 x 300 VA DIN dimmer	LG-003651	all	BT-F418U2	all
LG-573912 3 m touch control	LG-573912	11W27	BT-HC4657M3	11W09
	LG-573913	11W09	BT-HD4657M3	11W12
			BT-HS4657M3	11W12
4 m touch control			BT-HC4657M4	11W12
			BT-HD4657M4	11W12
			BT-HS4657M4	11W14
1 channel SCS/DALI interface	LG-002631	10W13	BT-F429	10W20
Basic actuator			BT-3475	12W31
BUS shutter DIN actuator	LG-003666	all	BT-F401	all
Control actuator	LG-067561	all	AR-64195	all
			AR-64196	all
			AR-64393	all
			BT-AM5852M2	all
			BT-H4672M2	all
			BT-LN4672M2	all
Basic control actuator			BT-3476	12W39
Control actuator	LG-067556	all	BT-LN4671M2	all
DIN dimmer for 0-10 V ballast	LG-002611	all	BT-BMD11001	all
BUS Dual Tech Green Switch	LG-067226	all	BT-L4658N	all
	LG-078486	all	BT-N4658N	all
	LG-574048	all	BT-NT4658N	all
	LG-574098	all	BT-HC4658	all
			BT-HD4658	all
			BT-HS4658	all
PIR BUS automatic switch	LG-067225	all	BT-L4659N	all
	LG-078485	all	BT-N4659N	all
	LG-574046	all	BT-NT4659N	all
	LG-574096	all	BT-HC4659	all
			BT-HD4659	all
			BT-HS4659	all
PIR ceiling mounted sensor	LG-048820	all	BT-BMSE3001	all
PIR+US double technology ceiling mounted sensor	LG-048822	all	BT-BMSE3003	all
IP55 PIR wall mounted sensor	LG-048834	all		
Memory module			BT-F425	10W01